

## DL1 Roll Up Assembly Instructions

1



Remove your roll up and bungee pole from the carry bag.

2



Take the pole and allow all three sections to slide together.

3

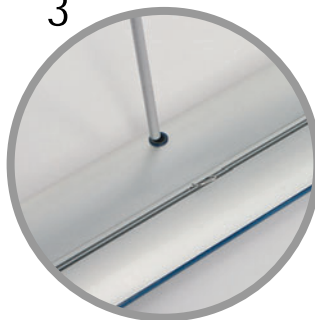

Insert the pole into the cassette, ensuring that it is fully located.

4



Pull the top rail straight upwards ensuring not to damage the graphic.

5



Hook the top rail onto the top of the pole.

